

A Better Conduit Outlet Body — Inside and Out!

T&B® Fittings

BlueKote™ Form 7 and Form 8
Conduit Outlet Bodies

*BlueKote™ internal
surface coating reduces
force required to pull wires*

*Cover with integral gasket
reduces inventory and chance of
misplacing a separate gasket!*

*Triple-layer protection — including
two layers of epoxy coating — stops
corrosion in its tracks!*



BlueKote™ Form 7 and Form 8 Conduit Outlet Bodies



Faster, Easier Wire Pulling and Extra Corrosion Resistance!

Why take a chance of damaging your wires while pulling them through conduit bodies? Thomas & Betts has enhanced its line of Form 7 and Form 8 conduit outlet bodies to outperform the competition in these areas and more. T&B BlueKote™ Form 7 and Form 8 conduit outlet bodies feature a slick, Teflon® based BlueKote™ interior finish to make wire pulling faster and easier than ever before and eliminate rough internal surfaces that can damage wires. To safeguard against corrosion, these conduit outlet bodies incorporate not one, not two, but three layers of protection — including two layers of epoxy coating. And to reduce inventory and provide up-front cost savings, both steel and iron covers now come standard with an integral neoprene gasket.



Four-layer protection for the ultimate in corrosion resistance!



Bare Conduit Body

Left in its raw state, all cast iron conduit bodies will rapidly corrode. Anytime the outer finish is compromised, corrosion will attack and propagate throughout the fitting.



Layer 1 — Electro Zinc Plating with Dichromate finish. This layer acts as a durable corrosion inhibitor. It protects the cast iron alloy conduit body from rust, and unlike painted coatings, prevents rust creep. This layer is an industry standard for corrosion resistance.



Layer 2 — Baked-On Epoxy Powder Coating. Epoxy is one of the most corrosion-resistant finishes available. This layer is powder coated, because unlike a conventionally painted surface, a powder-coated finish eliminates pinholes, cracks and crevices, is scratch resistant and holds up better against harsh chemicals.



Layer 3 — Baked-On Epoxy Paint. A final layer of epoxy paint provides the conduit outlet body with even more corrosion resistance.



Baked-On BlueKote™ Teflon® based coating inside the conduit outlet body provides a slick surface for easier wire pulling. It also provides more corrosion resistance on the inside of the conduit body by adding an additional layer of protection.



Form 7 and Form 8 Covers

BlueKote™ Teflon®-based internal finish

- Provides a slick, easy-glide internal surface
- Significantly lowers the amount of force necessary to pull wires
- Reduces installation time and risk of installer strain
- Eliminates rough internal surfaces that can cut into cable jacket, insulation and conductors during pulling

The Result

T&B BlueKote™ conduit outlet body and a leading competitor's conduit outlet body after a seven-day 5% salt-fog chamber test.

The T&B BlueKote™ conduit outlet body still has a glossy sheen and no evidence of salt adhesion or penetration.

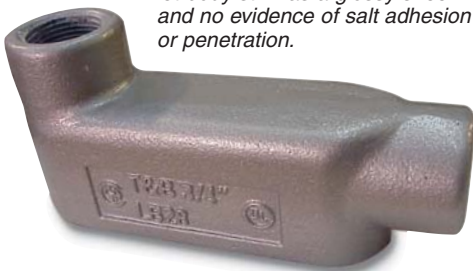

The competitor's conduit outlet body has severe salt adhesion and significant rusting.



| Cat. Number | Hub Size | Std. Pkg. Qty. | UPC Number |
|--|-----------|----------------|--------------|
| Form 7 Stamped Steel Cover with Integral Gasket | | | |
| 170S | 1/2" | 25 | 786210-98581 |
| 270S | 3/4" | 25 | 786210-98585 |
| 370S | 1" | 20 | 786210-98590 |
| 470S | 1 1/4" | 10 | 786210-98021 |
| 570S | 1 1/2" | 10 | 786210-98591 |
| 670S | 2" | 10 | 786210-98592 |
| 870S | 2 1/2"-3" | 5 | 786210-98594 |
| 970S | 3 1/2"-4" | 5 | 786210-98598 |
| Form 8 Stamped Steel Cover with Integral Gasket | | | |
| 180 | 1/2" | 25 | 786210-16494 |
| 280 | 3/4" | 25 | 786210-16495 |
| 380 | 1" | 25 | 786210-16498 |
| 480 | 1 1/4" | 10 | 786210-16500 |
| 580 | 1 1/2" | 10 | 786210-16504 |
| 680 | 2" | 10 | 786210-16506 |
| 680STB | 2 1/2"-3" | 5 | 786210-16515 |
| 980 | 3 1/2"-4" | 5 | 786210-16516 |
| Form 7 Iron Cover with Integral Gasket | | | |
| 170F | 1/2" | 20 | 786210-92379 |
| 270F | 3/4" | 20 | 786210-92381 |
| 370F | 1" | 50 | 786210-92412 |
| 470F | 1 1/4" | 5 | 786210-98020 |
| 570F | 1 1/2" | 5 | 786210-92413 |
| 670F | 2" | 5 | 786210-92420 |
| 870F | 2 1/2"-3" | 5 | 786210-92432 |
| 970F | 3 1/2"-4" | 5 | 786210-98598 |
| Form 8 Iron Cover with Integral Gasket | | | |
| 180F | 1/2" | 20 | 786210-16486 |
| 280F | 3/4" | 10 | 786210-16487 |
| 380F | 1" | 10 | 786210-16488 |
| 480F | 1 1/4" | 5 | 786210-16489 |
| 580F | 1 1/2" | 5 | 786210-16490 |
| 680F | 2" | 5 | 786210-16491 |
| 880F | 2 1/2"-3" | 5 | 786210-16492 |
| 980F | 3 1/2"-4" | 5 | 786210-16493 |
| Form 7 Replacement Gasket | | | |
| GASK 571 | 1/2" | 50 | 786210-93298 |
| GASK 572 | 3/4" | 50 | 786210-93299 |
| GASK 573 | 1" | 50 | 786210-93300 |
| GASK 574 | 1 1/4" | 5 | 786210-98023 |
| GASK 575 | 1 1/2" | 5 | 786210-93301 |
| GASK 576 | 2" | 5 | 786210-93303 |
| GASK 578 | 2 1/2"-3" | 5 | 786210-93307 |
| GASK 579 | 3 1/2"-4" | 5 | 786210-14738 |
| Form 8 Replacement Gasket | | | |
| GASK 581N | 1/2" | 20 | 786210-16527 |
| GASK 582N | 3/4" | 20 | 786210-16518 |
| GASK 583N | 1" | 10 | 786210-16521 |
| GASK 584N | 1 1/4" | 5 | 786210-16522 |
| GASK 585N | 1 1/2" | 5 | 786210-16524 |
| GASK 586N | 2" | 5 | 786210-16526 |
| GASK 588N | 2 1/2"-3" | 5 | 786210-16529 |
| GASK 589N | 3 1/2"-4" | 5 | 786210-16530 |





BlueKote™ Form 7 and Form 8 Conduit Outlet Bodies

| Cat. Number | Size | Dimensions (in.) | | | | | | Std. Pkg. Qty. | UPC Number |
|----------------------------|------|---------------------------------|---------------------------------|--------------------------------|--------------------------------|---------------------------------|-------|----------------|--------------|
| | | A | B | C | D | E | CI | | |
| LB Form 7 BlueKote™ | | | | | | | | | |
| LB17 | ½ | 4.60 | 2.20 | 1.35 | .95 | 3.20 | 4.0 | 25 | 786210-92460 |
| LB27 | ¾ | 5.25 | 2.40 | 1.65 | 1.15 | 3.80 | 6.6 | 20 | 786210-92461 |
| LB37 | 1 | 6.00 | 2.65 | 1.80 | 1.35 | 4.55 | 10.6 | 10 | 786210-92462 |
| LB47 | 1¼ | 6.45 | 3.20 | 2.20 | 1.80 | 5.00 | 18.8 | 20 | 786210-93337 |
| LB57 | 1½ | 7.25 | 3.90 | 2.45 | 2.05 | 5.45 | 26.4 | 10 | 786210-93338 |
| LB67 | 2 | 8.30 | 4.45 | 3.10 | 2.45 | 6.40 | 51.0 | 1 | 786210-93339 |
| LB77 | 2½ | 10.55 | 5.20 | 4.25 | 3.60 | 8.40 | 102.0 | 1 | 786210-93340 |
| LB87 | 3 | 10.55 | 5.95 | 4.25 | 3.60 | 8.40 | 132.0 | 1 | 786210-93341 |
| LB97 | 3½ | 12.85 | 6.70 | 5.25 | 4.55 | 10.25 | 210.0 | 1 | 786210-93342 |
| LB107 | 4 | 12.85 | 7.20 | 5.25 | 4.55 | 10.25 | 243.0 | 1 | 786210-93343 |
| LB Form 8 BlueKote™ | | | | | | | | | |
| LB18 | ½ | 4 ¹ / ₁₆ | 2.219 | 1 ¹ / ₁₆ | 1 | 3 ³ / ₁₆ | 4.9 | 25 | 786210-16560 |
| LB28 | ¾ | 5 ⁵ / ₁₆ | 2.438 | 1 ¹ / ₁₆ | 1 ¹ / ₁₆ | 3 ³ / ₁₆ | 8.0 | 20 | 786210-16565 |
| LB38 | 1 | 6 ¹ / ₁₆ | 2.813 | 1 ¹ / ₁₆ | 1 ¹ / ₁₆ | 4 ¹ / ₁₆ | 13.0 | 4 | 786210-16566 |
| LB448 | 1¼ | 7 ¹⁷ / ₃₂ | 3 ¹¹ / ₃₂ | 2 ³ / ₁₆ | 1 ¹ / ₁₆ | 5 ⁵ / ₁₆ | 23.5 | 10 | 786210-16567 |
| LB58 | 1½ | 9 ¹ / ₁₆ | 4 ¹ / ₁₆ | 2 ¹ / ₁₆ | 2 ¹ / ₁₆ | 6 ¹ / ₁₆ | 45.0 | 2 | 786210-16568 |
| LB68 | 2 | 11 | 4 ¹³ / ₃₂ | 3 ³ / ₄ | 3 | 8 ¹ / ₁₆ | 88.0 | 1 | 786210-16569 |
| LB78 | 2½ | 13 ¹ / ₁₆ | 6 ¹ / ₁₆ | 5 | 4 ¹ / ₁₆ | 10 ¹ / ₁₆ | 110.0 | 1 | 786210-16570 |
| LB888 | 3 | 13 ¹ / ₁₆ | 6 ¹ / ₁₆ | 5 | 4 ¹ / ₁₆ | 10 ¹ / ₁₆ | 110.0 | 1 | 786210-16571 |
| LB98 | 3½ | 16 ¹ / ₁₆ | 7 ¹ / ₁₆ | 6 ¹ / ₁₆ | 5 ¹ / ₁₆ | 1 ³ / ₁₆ | 250.0 | 1 | 786210-16572 |
| LB108 | 4 | 16 ¹ / ₁₆ | 7 ¹ / ₁₆ | 6 ¹ / ₁₆ | 5 ¹ / ₁₆ | 1 ³ / ₁₆ | 250.0 | ? | 786210-16573 |
| T Form 7 BlueKote™ | | | | | | | | | |
| T17 | ½ | 5.60 | 1.80 | 2.35 | .95 | 3.20 | 6.0 | 20 | 786210-92497 |
| T27 | ¾ | 6.20 | 2.00 | 2.60 | 1.15 | 3.80 | 9.1 | 10 | 786210-92498 |
| T37 | 1 | 7.35 | 2.30 | 3.10 | 1.35 | 4.55 | 16.9 | 10 | 786210-92499 |
| T47 | 1¼ | 7.30 | 2.30 | 3.05 | 1.80 | 5.00 | 19.3 | 20 | 786210-93442 |
| T57 | 1½ | 8.60 | 2.60 | 3.80 | 2.05 | 5.45 | 27.5 | 10 | 786210-93443 |
| T67 | 2 | 9.50 | 3.20 | 4.25 | 2.45 | 6.40 | 50.0 | 10 | 786210-93444 |
| T77 | 2½ | 12.10 | 3.65 | 5.80 | 3.60 | 8.40 | 102.0 | 1 | 786210-93445 |
| T87 | 3 | 12.10 | 4.40 | 5.80 | 3.60 | 8.40 | 132.0 | 1 | 786210-93446 |
| T97 | 3½ | 14.65 | 4.90 | 7.05 | 4.55 | 10.25 | 210.0 | 1 | 786210-93447 |
| T107 | 4 | 14.65 | 5.40 | 7.05 | 4.55 | 10.25 | 243.0 | 1 | 786210-93448 |
| T Form 8 BlueKote™ | | | | | | | | | |
| T18 | ½ | 5 ¹ / ₁₆ | 1 ¹ / ₁₆ | 25/32 | 1 | 3 ³ / ₁₆ | 6.0 | 20 | 786210-16609 |
| T28 | ¾ | 6 ³ / ₃₂ | 2 | 2 ⁵ / ₁₆ | 1 ¹ / ₁₆ | 3 ³ / ₁₆ | 9.0 | 10 | 786210-16610 |
| T38-TB | 1 | 7 ¹ / ₁₆ | 2 ¹ / ₁₆ | 2 ¹ / ₁₆ | 1 ¹ / ₁₆ | 4 ¹ / ₁₆ | 15.0 | 10 | 786210-16612 |
| T448 | 1¼ | 8 ¹ / ₁₆ | 2 ³ / ₁₆ | 3 ⁵ / ₃₂ | 1 ¹ / ₁₆ | 5 ⁵ / ₁₆ | 24.0 | 2 | 786210-16615 |
| T58 | 1½ | 10 ³ / ₁₆ | 2 ²⁵ / ₃₂ | 4 | 2 ¹ / ₁₆ | 6 ¹ / ₁₆ | 46.5 | 2 | 786210-16617 |
| T68 | 2 | 12 ¹ / ₄ | 3 ³ / ₁₆ | 5 | 3 | 8 ¹ / ₁₆ | 88.0 | 2 | 786210-16618 |
| T78 | 2½ | 15 ¹ / ₁₆ | 4 ¹ / ₁₆ | 6 ¹ / ₁₆ | 4 ¹ / ₁₆ | 10 ¹ / ₁₆ | 110.0 | 1 | 786210-16624 |
| T88-TB | 3 | 15 ¹ / ₁₆ | 4 ¹ / ₁₆ | 6 ¹ / ₁₆ | 4 ¹ / ₁₆ | 10 ¹ / ₁₆ | 110.0 | 1 | 786210-16625 |
| C Form 8 BlueKote™ | | | | | | | | | |
| C18 | ½ | 5 ¹⁷ / ₃₂ | 1 ¹ / ₁₆ | 1 ¹ / ₁₆ | 1 | 3 ³ / ₁₆ | 4.9 | 25 | 786210-16532 |
| C28 | ¾ | 6 ³ / ₃₂ | 1 ¹⁷ / ₃₂ | 1 ¹ / ₁₆ | 1 ¹ / ₁₆ | 3 ³ / ₁₆ | 8.0 | 25 | 786210-16534 |
| C38 | 1 | 7 ¹ / ₁₆ | 1 ¹⁵ / ₁₆ | 1 ¹ / ₁₆ | 1 ¹ / ₁₆ | 4 ¹ / ₁₆ | 13.0 | 20 | 786210-16536 |
| C448 | 1¼ | 8 ¹ / ₁₆ | 2 ³ / ₁₆ | 2 ³ / ₁₆ | 1 ¹ / ₁₆ | 5 ⁵ / ₁₆ | 23.5 | 2 | 786210-16538 |
| C58-TB | 1½ | 10 ¹ / ₁₆ | 2 ²⁵ / ₃₂ | 2 ¹ / ₁₆ | 2 ¹ / ₁₆ | 6 ¹ / ₁₆ | 45.0 | 10 | 786210-16539 |
| C68 | 2 | 12 ¹ / ₄ | 3 ³ / ₁₆ | 3 ³ / ₁₆ | 3 | 8 ¹ / ₁₆ | 88.0 | 2 | 786210-16549 |
| C78 | 2½ | 15 ¹ / ₁₆ | 4 ¹ / ₁₆ | 5 | 4 ¹ / ₁₆ | 10 ¹ / ₁₆ | 110.0 | 1 | 786210-16552 |
| C88 | 3 | 15 ¹ / ₁₆ | 4 ¹ / ₁₆ | 5 | 4 ¹ / ₁₆ | 10 ¹ / ₁₆ | 110.0 | 1 | 786210-16556 |
| LL Form 7 BlueKote™ | | | | | | | | | |
| LL17 | ½ | 4.60 | 1.40 | 1.45 | .95 | 3.20 | 4.0 | 25 | 786210-92487 |
| LL27 | ¾ | 5.25 | 1.60 | 1.65 | 1.15 | 3.80 | 6.6 | 20 | 786210-92492 |
| LL37 | 1 | 6.00 | 1.90 | 2.60 | 1.35 | 4.55 | 10.6 | 25 | 786210-92493 |
| LL47 | 1¼ | 6.45 | 2.30 | 3.05 | 1.80 | 5.00 | 18.6 | 20 | 786210-93344 |
| LL57 | 1½ | 7.90 | 2.60 | 3.80 | 2.05 | 5.45 | 26.4 | 10 | 786210-93346 |
| LL67 | 2 | 8.30 | 3.20 | 4.25 | 2.45 | 6.40 | 51.0 | 10 | 786210-93347 |
| LL77 | 2½ | 10.55 | 3.65 | 5.80 | 3.60 | 8.40 | 102.0 | 1 | 786210-93348 |
| LL87 | 3 | 10.55 | 4.40 | 5.80 | 3.60 | 8.40 | 132.0 | 1 | 786210-93349 |
| LL97 | 3½ | 12.85 | 4.90 | 7.03 | 4.55 | 10.25 | 210.0 | 1 | 786210-93350 |
| LL107 | 4 | 12.85 | 5.40 | 7.03 | 4.55 | 10.25 | 243.0 | 1 | 786210-93351 |
| LL Form 8 BlueKote™ | | | | | | | | | |
| LL18 | ½ | 4 ¹ / ₁₆ | 1 ¹ / ₁₆ | 2 ⁵ / ₃₂ | 1 | 3 ³ / ₁₆ | 4.9 | 25 | 786210-16577 |
| LL28 | ¾ | 5 ⁵ / ₁₆ | 1 ¹¹ / ₁₆ | 2 ¹ / ₁₆ | 1 ¹ / ₁₆ | 3 ³ / ₁₆ | 8.0 | 20 | 786210-16578 |
| LL38 | 1 | 6 ¹ / ₁₆ | 1 ¹⁵ / ₁₆ | 2 ¹ / ₁₆ | 1 ¹ / ₁₆ | 4 ¹ / ₁₆ | 13.0 | 25 | 786210-16579 |
| LL448 | 1¼ | 7 ¹⁷ / ₃₂ | 2 ³ / ₁₆ | 3 ⁵ / ₃₂ | 1 ¹ / ₁₆ | 5 ⁵ / ₁₆ | 23.5 | 20 | 786210-16580 |
| LL58 | 1½ | 9 ¹ / ₁₆ | 2 ²⁵ / ₃₂ | 4 | 2 ¹ / ₁₆ | 6 ¹ / ₁₆ | 45.0 | 10 | 786210-16581 |
| LL68 | 2 | 11 | 3 ³ / ₁₆ | 5 | 3 | 8 ¹ / ₁₆ | 88.0 | 5 | 786210-16582 |
| LL78 | 2½ | 13 ¹ / ₁₆ | 4 ¹ / ₁₆ | 6 ¹ / ₁₆ | 4 ¹ / ₁₆ | 10 ¹ / ₁₆ | 110.0 | 1 | 786210-16594 |
| LL888 | 3 | 13 ¹ / ₁₆ | 4 ¹ / ₁₆ | 6 ¹ / ₁₆ | 4 ¹ / ₁₆ | 10 ¹ / ₁₆ | 110.0 | 1 | 786210-16595 |

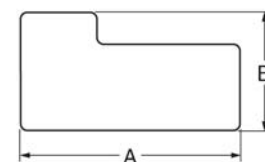
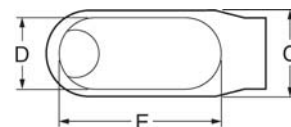

LB Form 7 and Form 8

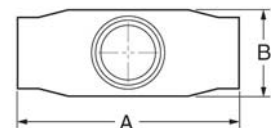
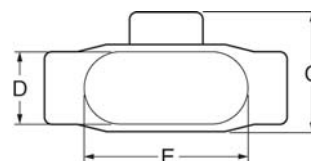

T Form 7 and Form 8

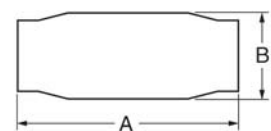
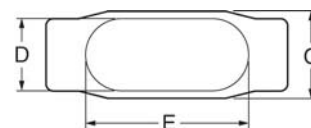

C Form 7 and Form 8

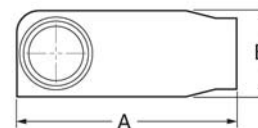
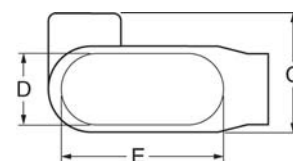

LL Form 7 and Form 8



BlueKote™ Form 7 and Form 8 Conduit Outlet Bodies (continued)

| Cat. Number | Size | Dimensions (in.) | | | | | Std. Pkg. Qty. | UPC Number |
|----------------------------|------|-------------------|------------------|------------------|------------------|------------------|----------------|--------------|
| | | A | B | C | D | E | | |
| LR Form 7 BlueKote™ | | | | | | | | |
| LR17 | ½ | 4.60 | 1.40 | 1.45 | .95 | 3.20 | 4.0 | 786210-92494 |
| LR27 | ¾ | 5.25 | 1.60 | 1.65 | 1.15 | 3.80 | 6.6 | 786210-92495 |
| LR37 | 1 | 6.00 | 1.90 | 2.60 | 1.35 | 4.55 | 10.6 | 786210-92496 |
| LR47 | 1¼ | 6.45 | 2.30 | 3.05 | 1.80 | 5.00 | 18.8 | 786210-93352 |
| LR57 | 1½ | 7.90 | 2.60 | 3.80 | 2.05 | 5.45 | 26.4 | 786210-93354 |
| LR67 | 2 | 8.30 | 3.20 | 4.25 | 2.45 | 6.40 | 51.0 | 786210-93436 |
| LR77 | 2½ | 10.55 | 3.65 | 5.80 | 3.60 | 8.40 | 102.0 | 786210-93438 |
| LR87 | 3 | 10.55 | 4.40 | 5.80 | 3.60 | 8.40 | 132.0 | 786210-93439 |
| LR97 | 3½ | 12.85 | 4.90 | 7.03 | 4.55 | 10.25 | 210.0 | 786210-93440 |
| LR107 | 4 | 12.85 | 5.40 | 7.03 | 4.55 | 10.25 | 243.0 | 786210-93441 |
| LR Form 8 BlueKote™ | | | | | | | | |
| LR18 | ½ | 4½ ₁₆ | 1½ ₁₆ | 2½ ₃₂ | 1 | 3½ ₁₆ | 4.4 | 786210-16596 |
| LR28 | ¾ | 5½ ₁₆ | 1½ ₁₆ | 2½ ₁₆ | 1½ ₁₆ | 3½ ₁₆ | 8.0 | 786210-16597 |
| LR38 | 1 | 6½ ₃₂ | 1½ ₁₆ | 2½ | 1½ | 4½ ₁₆ | 13.0 | 786210-16599 |
| LR448 | 1¼ | 7½ ₃₂ | 2½ | 3½ ₃₂ | 1½ | 5½ ₁₆ | 23.6 | 786210-16600 |
| LR58 | 1½ | 9½ | 2½ ₃₂ | 4 | 2½ | 6½ | 45.0 | 786210-16601 |
| LR68 | 2 | 11 | 3½ ₁₆ | 5 | 3 | 8½ ₁₆ | 88.0 | 786210-16606 |
| LR78 | 2½ | 13½ ₁₆ | 4½ ₁₆ | 6½ ₁₆ | 4½ | 10½ | 110.0 | 786210-16607 |
| LR888 | 3 | 13½ ₁₆ | 4½ ₁₆ | 6½ ₁₆ | 4½ | 10½ | 110.0 | 786210-16608 |
| L Form 7 BlueKote™ | | | | | | | | |
| L17-TB | ½ | 4.60 | 1.40 | 1.45 | .95 | 3.20 | — | 786210-08666 |
| L27-TB | ¾ | 5.25 | 1.60 | 1.65 | 1.15 | 3.80 | — | 786210-08667 |
| L37-TB | 1 | 6.00 | 1.90 | 2.60 | 1.35 | 4.55 | — | 786210-08668 |
| L47-TB | 1¼ | 6.45 | 2.30 | 3.05 | 1.80 | 5.00 | — | 786210-08669 |
| L57-TB | 1½ | 7.90 | 2.60 | 3.80 | 2.05 | 5.45 | — | 786210-08677 |
| L67-TB | 2 | 8.30 | 3.20 | 4.25 | 2.45 | 6.40 | — | 786210-08678 |
| TB Form 8 BlueKote™ | | | | | | | | |
| TB18 | ½ | 5½ ₁₆ | 2½ | 1½ | 1 | 3½ ₁₆ | 6.0 | 786210-16626 |
| TB28 | ¾ | 6½ ₃₂ | 2½ | 1½ ₁₆ | 1½ ₁₆ | 3½ ₁₆ | 9.0 | 786210-16627 |
| TB38 | 1 | 7½ ₁₆ | 3½ | 1½ | 1½ | 4½ ₁₆ | 15.0 | 786210-19946 |
| TB448 | 1¼ | 8½ | 3½ ₁₆ | 2½ ₁₆ | 1½ | 5½ ₁₆ | 24.0 | 786210-16629 |
| TB58 | 1½ | 10½ | 3½ ₁₆ | 2½ | 2½ | 6½ | 46.5 | 786210-16631 |
| TB68 | 2 | 12½ | 4½ | 3½ | 3 | 8½ ₁₆ | 88.0 | 786210-16633 |
| X Form 7 BlueKote™ | | | | | | | | |
| X17 | ½ | 5.60 | 1.80 | 3.05 | .95 | 3.20 | 6.0 | 786210-08460 |
| X27 | ¾ | 6.20 | 2.00 | 3.30 | 1.15 | 3.80 | 9.1 | 786210-08470 |
| X37 | 1 | 7.35 | 2.30 | 3.80 | 1.35 | 4.55 | 16.9 | 786210-08472 |
| X47 | 1¼ | 7.30 | 2.30 | 3.85 | 1.80 | 5.00 | 19.3 | 786210-08663 |
| X57 | 1½ | 8.60 | 2.60 | 5.05 | 2.05 | 5.45 | 27.5 | 786210-08664 |
| X67 | 2 | 9.50 | 3.20 | 5.45 | 2.45 | 6.40 | 52.8 | 786210-08665 |
| X Form 8 BlueKote™ | | | | | | | | |
| X18 | ½ | 5½ ₁₆ | 1½ | 2½ ₃₂ | 1 | 3½ ₁₆ | 6.0 | 786210-16634 |
| X28 | ¾ | 6½ ₃₂ | 2 | 3½ ₁₆ | 1½ | 3½ ₁₆ | 9.0 | 786210-16635 |
| X38 | 1 | 7½ ₁₆ | 2½ | 3½ | 1½ | 4½ ₁₆ | 15.0 | 786210-16636 |
| X448 | 1¼ | 8½ | 2½ | 4½ | 1½ | 5½ ₁₆ | 24.0 | 786210-16638 |
| X58 | 1½ | 10½ | 2½ ₃₂ | 5½ | 2½ | 6½ | 46.5 | 786210-16639 |
| X68 | 2 | 12½ | 3½ ₁₆ | 6½ | 3 | 8½ ₁₆ | 88.0 | 786210-16641 |
| E Form 7 BlueKote™ | | | | | | | | |
| E17 | ½ | 4.60 | 1.40 | 1.45 | .95 | 3.20 | 6.0 | 786210-08679 |
| E27 | ¾ | 5.25 | 1.60 | 1.65 | 1.15 | 3.80 | 9.1 | 786210-08680 |
| E37 | 1 | 6.00 | 1.90 | 1.80 | 1.35 | 4.55 | 16.9 | 786210-08681 |

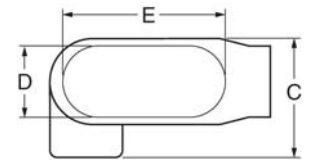

LR Form 7 and Form 8

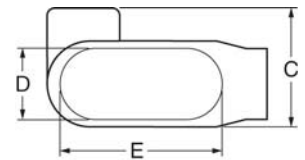

L Form 7

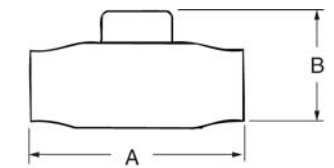
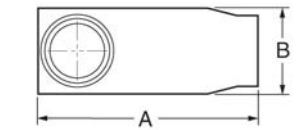

TB Form 8

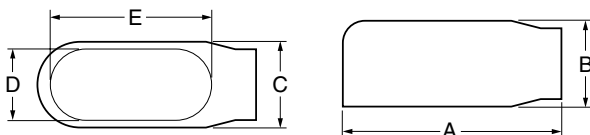
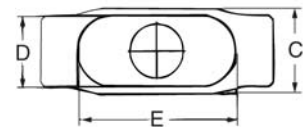

E Form 7

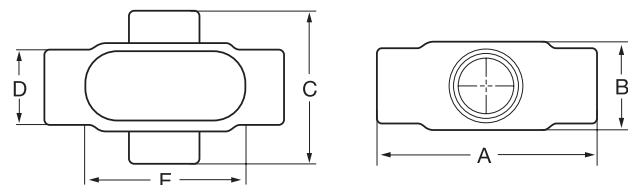

X Form 7 and Form 8



Order T&B BlueKote™ Form 7 Conduit Outlet Bodies Pre-Assembled with Covers and Gaskets!

For your convenience and inventory reduction, T&B BlueKote™ Form 7 Conduit Outlet Bodies can be purchased pre-assembled with body, stamped steel cover and integral gasket all included. To order, simply add CG-TB to the catalog number for any Form 7 Conduit Outlet Body. For example, Catalog No. LB27CG-TB is an LB27 ¾" LB-style BlueKote™ Form 7 conduit outlet body pre-assembled with 270S stamped steel cover with integral neoprene gasket.



T&B® Pre-Assembled Bodies, Gaskets and Covers

| Cat. Number | Trade Size | Pre-Assembled Products | Std. Pkg. Qty. | UPC Number |
|-------------|------------|---------------------------|----------------|--------------|
| C17CG-TB | ½" | C17 Body, Cover & Gasket | 10 | 786210-91679 |
| C27CG-TB | ¾" | C27 Body, Cover & Gasket | 5 | 786210-91680 |
| C37CG-TB | 1" | C37 Body, Cover & Gasket | 5 | 786210-91681 |
| C47CG-TB | 1½" | C47 Body, Cover & Gasket | 2 | 786210-91682 |
| C57CG-TB | 1½" | C57 Body, Cover & Gasket | 2 | 786210-91683 |
| C67CG-TB | 2" | C67 Body, Cover & Gasket | 2 | 786210-91684 |
| LB17CG-TB | ½" | LB17 Body, Cover & Gasket | 5 | 786210-91667 |
| LB27CG-TB | ¾" | LB27 Body, Cover & Gasket | 5 | 786210-91668 |
| LB37CG-TB | 1" | LB37 Body, Cover & Gasket | 5 | 786210-91669 |
| LB47CG-TB | 1½" | LB47 Body, Cover & Gasket | 2 | 786210-91670 |
| LB57CG-TB | 1½" | LB57 Body, Cover & Gasket | 5 | 786210-91671 |
| LB67CG-TB | 2" | LB67 Body, Cover & Gasket | 2 | 786210-91672 |
| LL17CG-TB | ½" | LL17 Body, Cover & Gasket | 5 | 786210-91685 |
| LL27CG-TB | ¾" | LL27 Body, Cover & Gasket | 5 | 786210-91686 |
| LL37CG-TB | 1" | LL37 Body, Cover & Gasket | 5 | 786210-91687 |
| LL47CG-TB | 1½" | LL47 Body, Cover & Gasket | 2 | 786210-91688 |
| LL57CG-TB | 1½" | LL57 Body, Cover & Gasket | 2 | 786210-91689 |
| LL67CG-TB | 2" | LL67 Body, Cover & Gasket | 2 | 786210-91690 |
| LR17CG-TB | ½" | LR17 Body, Cover & Gasket | 5 | 786210-91691 |
| LR27CG-TB | ¾" | LR27 Body, Cover & Gasket | 5 | 786210-91693 |
| LR37CG-TB | 1" | LR37 Body, Cover & Gasket | 5 | 786210-91694 |
| LR47CG-TB | 1½" | LR47 Body, Cover & Gasket | 2 | 786210-91695 |
| LR57CG-TB | 1½" | LR57 Body, Cover & Gasket | 2 | 786210-91696 |
| LR67CG-TB | 2" | LR67 Body, Cover & Gasket | 2 | 786210-91697 |
| T17CG-TB | ½" | T17 Body, Cover & Gasket | 5 | 786210-91673 |
| T27CG-TB | ¾" | T27 Body, Cover & Gasket | 5 | 786210-91674 |
| T37CG-TB | 1" | T37 Body, Cover & Gasket | 2 | 786210-91675 |
| T47CG-TB | 1½" | T47 Body, Cover & Gasket | 2 | 786210-91676 |
| T57CG-TB | 1½" | T57 Body, Cover & Gasket | 2 | 786210-91677 |
| T67CG-TB | 2" | T67 Body, Cover & Gasket | 2 | 786210-91678 |
| TB17CG-TB | ½" | TB17 Body, Cover & Gasket | 5 | 786210-91698 |
| TB27CG-TB | ¾" | TB27 Body, Cover & Gasket | 5 | 786210-91699 |
| TB37CG-TB | 1" | TB37 Body, Cover & Gasket | 2 | 786210-91700 |
| TB47CG-TB | 1½" | TB47 Body, Cover & Gasket | 2 | 786210-91701 |
| TB57CG-TB | 1½" | TB57 Body, Cover & Gasket | 2 | 786210-91702 |
| TB67CG-TB | 2" | TB67 Body, Cover & Gasket | 2 | 786210-91703 |
| X17CG-TB | ½" | X17 Body, Cover & Gasket | 5 | 786210-91704 |
| X27CG-TB | ¾" | X27 Body, Cover & Gasket | 2 | 786210-91705 |
| X37CG-TB | 1" | X37 Body, Cover & Gasket | 1 | 786210-91706 |
| X47CG-TB | 1½" | X47 Body, Cover & Gasket | 2 | 786210-91707 |
| X57CG-TB | 1½" | X57 Body, Cover & Gasket | 1 | 786210-91708 |
| X67CG-TB | 2" | X67 Body, Cover & Gasket | 1 | 786210-91710 |

Sample Specifications for Conduit Outlet Bodies:

1. For protection against corrosion, conduit bodies are to have an electro galvanized finish, followed by a baked-on powder epoxy finish to a minimum of 2.5 mil thickness, and at least one additional baked layer of epoxy applied with an additional 2.0 mil thickness or better.
2. To aid in wire pull, and reduce wire damage, the interior of the conduit bodies are to include a baked-on Teflon® based coating of 2.0 mils minimum thickness.

www.tnb.com

Thomas&Betts

信德迈科技(北京)有限公司 CNMEC Technology Company
地址：北京市朝阳区望京SOHO-T1-C座2115室 邮编：100102

*Tel: 010-8428 2935 | * Fax: 010-8428 8762
*手机：139 1096 2635
*电子邮件：sales@cnmec.biz
主页：http://www.cnmec.biz