

# 旗型端头

## 非绝缘旗型端头

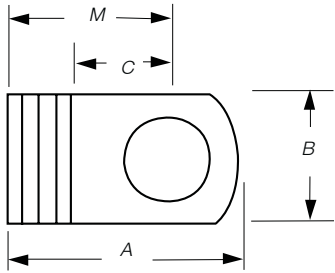

产品编号	数量	导线规格范围	螺栓孔	推荐工具	尺寸				材料厚度		
					A	B	C	M			
AB14-6A	100	22-14	#6	ERG4004	.55	.31	.22	.39	.03		
AB51	1,000	22-14	#6		.55	.31	.22	.39			
AB14-8A	100	22-14	#8		.55	.31	.22	.39			
AB52	1,000	22-14	#8		.55	.31	.22	.39			
AB14-10A	100	22-14	#10		.55	.31	.22	.39			
AB53	1,000	22-14	#10		.55	.31	.22	.39			
C51	500	12-10	#6		.66	.31	.25	.48		.04	
C10-8A	50	12-10	#8		.66	.31	.25	.48			
C52	500	12-10	#8		.66	.31	.25	.48			
C10-10A	50	12-10	#10		.66	.31	.25	.48			
C53	500	12-10	#10	.66	.31	.25	.48				
D236	200	8	#10	WT129	.83	.50	.25	.59	.06		
D226	200	8	#10		.90	.50	.29	.64			
D271	200	8	1/4"		.92	.50	.33	.68			
E226	200	6	#10		.93	.50	.29	.69			
E271	200	6	1/4"		.99	.50	.33	.73			
E272	200	6	5/16"		1.05	.50	.41	.81			
F226	200	4	#10		1.07	.56	.33	.80		.07	
F271	200	4	1/4"		1.10	.63	.33	.80			
F272	200	4	5/16"		1.18	.63	.41	.88			
F273	200	4	3/8"		1.20	.63	.43	.90			
G671	100	2	1/4"	13642M	1.20	.63	.33	.89	.08		
G672	100	2	5/16"		1.28	.63	.41	.97			
G673	100	2	3/8"		1.32	.63	.46	1.02			
H672	50	1/0	5/16"		1.31	.63	.41	1.01		.10	
H673	50	1/0	3/8"		1.36	.63	.46	1.06			
J672	50	2/0	5/16"		1.46	.75	.41	1.10			
J673	50	2/0	3/8"		1.51	.75	.46	1.15			
J675	50	2/0	1/2"		1.67	.75	.55	1.24			
K672	50	3/0	5/16"		13642M	1.59	.81	.41		1.19	.11
K673	50	3/0	3/8"			1.64	.81	.46		1.24	
K675	50	3/0	1/2"	1.76		.81	.55	1.34			
M673	50	250kcmil	3/8"	1.89		1.0	.46	1.43	.13		
M675	50	250kcmil	1/2"	1.99		1.0	.55	1.52			

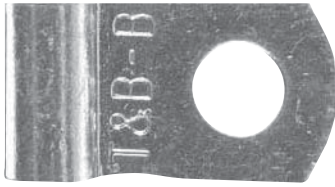